

# SOLID Vibration Transducers – Overview

All SOLID transducers are internally isolated. The frequency range is specified for the transducer when permanently installed. The measuring results will be affected at higher frequencies when using a magnetic foot.

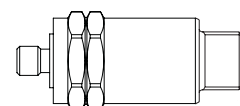

## Vibration Transducers

Article no.	Ex	Thread	Connector	Frequency range	Sensitivity	Compatible with	TD sheet
SLD 121 B	–	M8	2-pin	2–1000 Hz	1.2 mV/m/s <sup>2</sup>	CMM, MG4/MG4-A, Intellinova	TD-283
SLD 121 F	–	UNF 1/4"	2-pin	2–1000 Hz	1.2 mV/m/s <sup>2</sup>	CMM, MG4/MG4-A, Intellinova	TD-283
SLD 122 B	–	M8	2-pin	2–5000 Hz	4 mV/m/s <sup>2</sup>	MG4/MG4-A, Intellinova	TD-283
SLD 122 F	–	UNF 1/4"	2-pin	2–5000 Hz	4 mV/m/s <sup>2</sup>	MG4/MG4-A, Intellinova	TD-283
SLD 144 B	–	M8	2-pin	2–10 000 Hz	10 mV/m/s <sup>2</sup>	LEO, VCM, MG4-A, Intellinova	TD-283
SLD 144 F	–	UNF 1/4"	2-pin	2–10 000 Hz	10 mV/m/s <sup>2</sup>	LEO, VCM, MG4-A, Intellinova	TD-283
SLD 243 B	Ex	M8	2-pin	2–10 000 Hz	5 mV/m/s <sup>2</sup>	LEO, VCM, MG4-A, Intellinova	TD-215
SLD 243 F	Ex	UNF 1/4"	2-pin	2–10 000 Hz	5 mV/m/s <sup>2</sup>	LEO, VCM, MG4-A, Intellinova	TD-215
SLD 244 B	Ex	M8	2-pin	2–10 000 Hz	10 mV/m/s <sup>2</sup>	LEO, VCM, MG4-A, Intellinova	TD-215
SLD 244 F	Ex	UNF 1/4"	2-pin	2–10 000 Hz	10 mV/m/s <sup>2</sup>	LEO, VCM, MG4-A, Intellinova	TD-215

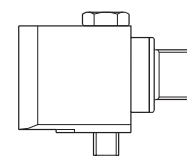

## Vibration Transducers with Side Entry

Article no.	Ex	Thread	Connector	Frequency range	Sensitivity	Compatible with	TD sheet
SLD 144 S	–	M8	2-pin	2–10 000 Hz	10 mV/m/s <sup>2</sup>	LEO, VCM, MG4-A, Intellinova	TD-282
SLD 144 S-UNF	–	UNF 1/4"	2-pin	2–10 000 Hz	10 mV/m/s <sup>2</sup>	LEO, VCM, MG4-A, Intellinova	TD-282
SLD 244 S	Ex	M8	2-pin	2–10 000 Hz	10 mV/m/s <sup>2</sup>	LEO, VCM, MG4-A, Intellinova	TD-300
SLD 244 S-UNF	Ex	UNF 1/4"	2-pin	2–10 000 Hz	10 mV/m/s <sup>2</sup>	LEO, VCM, MG4-A, Intellinova	TD-300

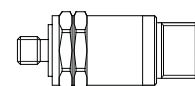

## Vibration Transducers MEMS

Article no.	Ex	Thread	Connector	Frequency range	Sensitivity	Compatible with	TD sheet
SLD 322B-M8	–	M8	2-pin	1–1000 (5000) Hz	4 mV/m/s <sup>2</sup>	LEO, VCM, MG4-A, Intellinova	TD-302
SLD 322B-UNF	–	UNF 1/4"	2-pin	1–1000 (5000) Hz	4 mV/m/s <sup>2</sup>	LEO, VCM, MG4-A, Intellinova	TD-302
SLD 334B-M8	–	M8	2-pin	1–1000 (5000) Hz	10 mV/m/s <sup>2</sup>	LEO, VCM, MG4-A, Intellinova	TD-302
SLD 334B-UNF	–	UNF 1/4"	2-pin	1–1000 (5000) Hz	10 mV/m/s <sup>2</sup>	LEO, VCM, MG4-A, Intellinova	TD-302

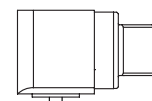

## Vibration Transducers MEMS with Side Entry

Article no.	Ex	Thread	Connector	Frequency range	Sensitivity	Compatible with	TD sheet
SLD 334S-G	–	M3/Glue	2-pin	1–1000 (5000) Hz	10 mV/m/s <sup>2</sup>	LEO, VCM, MG4-A, Intellinova	TD-465

**Note:** Ex approved transducers must be used together with transducer interface SPM 15226 or Ex approved zener barrier when used in explosive environment and measured with a non EX approved instrument outside the EX environment.

