

HYDRAULIC SPREADERS / LIFTING WEDGES

BETEX 15 TL / 15 TLS / 25 TLS HYDRAULIC SPREADERS / LIFTING WEDGES



15 TL spreader



25 TLS lifting wedge / spreader



15 TLS lifting wedge / spreader

These patented Special Tools are easy to use and designed to spread or lift loads such as motors, gearboxes and flanges with ease and superior accuracy.

- Loads are lifted perpendicularly.
- Ideal for numerous industrial maintenance repair jobs
- Accurate height adjustments (shaft alignment) can easily be executed by one person
- Easy, light and very practical to use
- Suitable for spaces of 5 to 43 mm.
- Due to the reduced thickness of the jaws, made of high quality hardened steel, these wedges can be used for jobs where working space is extremely limited
- Including safety block to secure the load and remove the lifting wedge/spreader



Sets

Various combination sets are available in a carrying case. All sets are pre-mounted, you can get started right away!

- Hydraulic spreaders or lifting wedge
- Lightweight, 2-stage hand pump
- Hose, 1.5 mtr
- Stepped safety block
- Manometer, T-adapter
- Male (hose) half coupler, complete quick coupler
- Steel storage case



Duo-sets

For more working accuracy, we supply duo-sets with two flange spreaders and a pump with manifold for separate oil flow.

- The lifting and spreading capacity is doubled
- The lifting force is divided evenly and more accurately, thus preventing loads to be pressed askew or lop-sided burdening
- Safe: Perfect straight lifting movement prevents the load from tilting

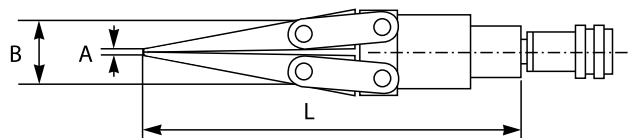

TIP! Use in combination with Betex shims, page 140 -142

Type	Art. no.	Function	Max. cap ton	Pump type	Max. pressure bar	A mm	B mm	L mm	Weight Kg
15 TL	789170	spreading	15	single-acting	700	5	40	235	4
15 TL SET	789180	spreading	15	single-acting	700	5	40	235	16
15 TL duo-set	789181	spreading	2 x 15	single-acting	700	5	40	235	28
15 TLS	789150	lifting & spreading	15	single-acting	700	5	40	235	4
15 TLS set	789160	lifting & spreading	15	single-acting	700	5	40	235	16
15 TLS duo-set	789162	lifting & spreading	2 x 15	single-acting	700	5	40	235	28
25 TLS	789250	lifting & spreading	25	single-acting	700	8	43	342	8
25 TLS set	789260	lifting & spreading	25	single-acting	700	8	43	342	20
25 TLS duo-set	789261	lifting & spreading	2 x 25	single-acting	700	8	43	342	36

HYDRAULIC LIFTING WEDGE

BETEX HLW 18T HYDRAULIC VERTICAL LIFTING WEDGE - 18 TON

Specially designed to raise or lower heavy loads in one fluent, straight, vertical movement. The HLW series guarantees a safe and solid grip. For use on flanges with a minimum opening of 9.5 mm.

- Lifting heavy loads, placing and moving machines, and machine alignment.
- Maintenance, mounting and dismounting activities.
- Steady lift movement, fluent, straight, vertical lifting.
- Robust and exact, solid fixed grip at every stage by using the stepped blocks.
- Safe, saves time and costs, ergonomic design.
- Single-acting piston, spring return.
- Applicable at minimum openings of 9.5 mm.
- Lifting capacity: per step 19 mm lifting height.
- Maximum lift when using a multi-stage block of 67.5 mm.
- Lifting power: max. 36 tons (using 2 pcs. HLW 18T(l) or duo-set).
- With safety block to secure the load and remove the lifting wedge



Sets

Various combination sets available in carrying case. All sets are pre-mounted, you can get started right away!

- Hydraulic lifting wedge
- 2-stage hand pump
- Hose 2.1 mtr
- Stepped safety block + multi-stage block
- Manometer, T-adaptor
- Male (hose) half coupler, complete quick coupler
- PE case

Duo-sets

For more working accuracy, we supply duo-sets with two lifting wedges and a pump with manifold for separate oil flow:

- The lifting capacity is doubled
- The lifting force is divided evenly and more accurately, thus preventing loads to be pressed askew or lopsided burdening
- Safe: Perfect straight lifting movement prevents the load from tilting



HLW 18TI hydraulic lifting wedge with integrated pump

Type HLW 18TI has a built-in hydraulic system for which a separate hose, coupler and hand pump are not necessary. The spreader is supplied in a case. Not available as duo-set.

Lifting height:

- 9.5 mm – 29.5 mm by using the first step
- 9.5 mm – 51 mm using 4 steps (without multi-stage blocks)
- 39.5 – 67.5 mm (using multi-stage blocks)

BETEX HLW 18T

Type	Art. no.	max. cap.: ton	Spread mm	Pump type	Max. pressure bar	Weight Kg
HLW 18T	789501	18	9.5 – 67.5*	single-acting	700	10.8
HLW 18T set (complete in case)	789502	18	9.5 – 67.5*	single-acting	700	24.6
HLW 18T duo-set (complete in case)	789503	2 x 18	9.5 – 67.5*	single-acting	700	37
HLW 18TI with integrated pump (complete in case)	789504	18	9.5 – 67.5*	single-acting	700	16

* using multi-stage block

MECHANICAL FLANGE SPREADER

BETEX MFS 7T MECHANICAL FLANGE SPREADER



For use on small flanges with a minimum opening of 2.0 mm. This flange spreader generates a spreading force of 7 ton.

- Innovative design with reversible claws gives a greater range of applications.
- Ergonomic design, lightweight but robust.
- Minimum access gap of 2.0 mm.

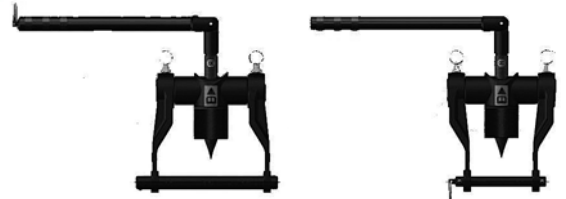

Innovative design with reversible claws

Advantages

Locks onto the flanged joint

- Safe to use
- Easy to operate
- Saves time and costs
- Portable
- In compact PE-case

Capacity

- Use as single piece: 7 ton
- Use in pair (2 pieces): 14 ton (recommended, larger spreading force)
- Flange opening: min. 2.00 mm
- Weight incl. case: 7 kg



BETEX MFS 7T

Type	Art. no.	Spreading force ton	Bolt size	Standard wedge mm	Claw width mm	Weight incl. case Kg
MFS 7T	789400	7	M16 / M20	2 - 27	91 - 152	7

HYDRAULICAL FLANGE SPREADERS

BETEX PFS 10T HYDRAULIC FLANGE SPREADERS



PFS 10T



PFS 10TI with integrated pump

- For safe and easy flange spreading.
- No more use of hammer and chisel, so less strenuous, time saving and most of all safe working.
- Use flange spreaders in sets for an even higher spreading force.
- Adjustable claw widths from 104 mm to 216 mm for a large number of applications.
- Special wedge for lager spread.
- Usable up to a max. flange width of 2 x 92 mm. The flange bolt has a min. diameter of 31.75 mm.
- Including safety block to remove the spreader and carry the load.



Safety block



PFS 10T Set

Sets

Various combination sets available in carrying case. All sets are pre-mounted, you can get started right away!

- Hydraulic flange spreader
- 2-stage hand pump
- Hose 1.5 mtr
- Safety block
- Manometer, T-adaptor
- Male (hose) half coupler, complete quick coupler
- Steel storage case



PFS 10T Duo-set

Duo-sets

For more working accuracy, we supply duo-sets with two flange spreaders and a pump with manifold for separate oil flow:

- The spreading capacity is doubled
- Parallel spreading: the spreading force is divided evenly and more accurately

PFS 10TI hydraulic flange spreader with integrated pump

Type PFS 10TI has a built-in hydraulic system for which a separate hose, coupler and hand pump are not necessary. The spreader is supplied in a case. Not available as duo-set.

BETEX PFS 10T

Type	Art. no.	Spreading force ton	Bolt size	Standard wedge	Claw width mm	Pump type	Weight Kg
PFS 10T	789410	10	M33	3.3 - 28.7	104 - 216	single-acting	15
PFS 10T Set (case included)	789411	10	M33	3.3 - 28.7	104 - 216	single-acting	25.2
PFS 10T Duo-set (case included)	789412	2 x 10	M33	3.3 - 28.7	104 - 216	single-acting	46.6
PFS 10TI Integrated pump (case included)	789413	10	M33	3.3 - 28.7	104 - 216	single-acting	17.5